

2430 mm

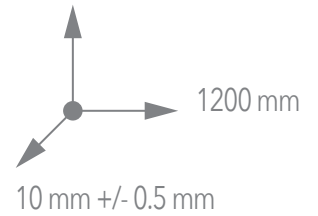

ca. 20 kg / Platte  
 ca. 20 kg / pannello

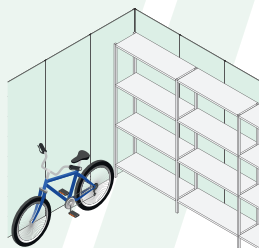
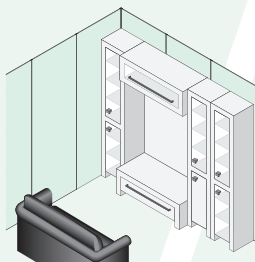
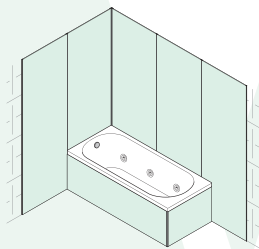
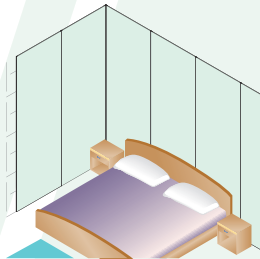
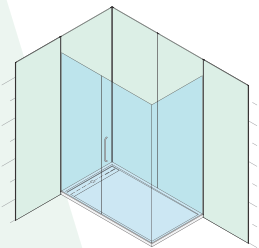

Abschluss-profil für RENOVA R6  
 Profilo terminale per RENOVA R6

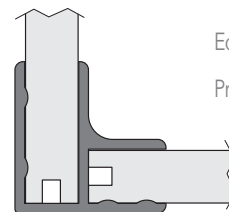

Eck-profil für RENOVA R6  
 Profilo angolare RENOVA R6

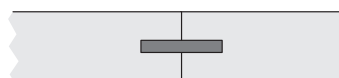

Verbindungs-profil RENOVA R6  
 Verbindungs-profil RENOVA R6